

DETAIL SEALANT PW OR LM-95 LIQUID MEMBRANE APPLIED TO THE TOP EDGE OF TERMINATION BAR AND TO COVER MINIMUM 1/8" BEYOND PERIMETER OF FASTENER HEADS

PRM APPLIED TO SUBSTRATE PREPARED WITH 650 LT LIQUID ADHESIVE OR CALIFORNIA SEALANT AT A RATE OF 250 - 300 SF/GAL OR 650 WB LIQUID ADHESIVE AT A RATE OF 350 TO 400 SF/GAL - OVERLAPS ARE 2 1/2" ON SIDE LAPS 6" ON END LAPS

DETAIL SEALANT PW OR LM-95 LIQUID MEMBRANE APPLIED TO SEAMS 12" FROM CHANGES IN PLANE, CONTINUOUSLY AND ALONG TERMINAL EDGES

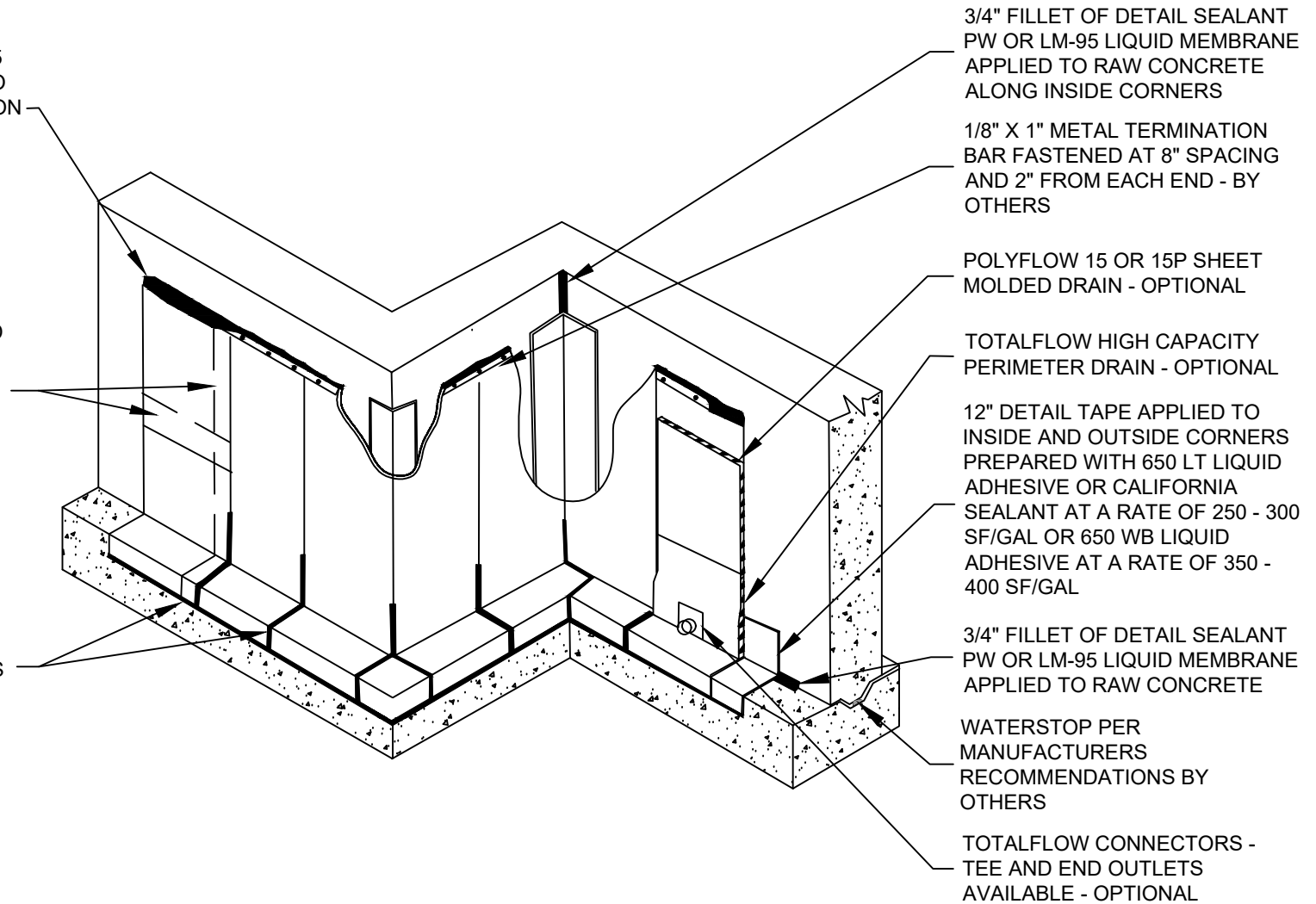

3/4" FILLET OF DETAIL SEALANT PW OR LM-95 LIQUID MEMBRANE APPLIED TO RAW CONCRETE ALONG INSIDE CORNERS

1/8" X 1" METAL TERMINATION BAR FASTENED AT 8" SPACING AND 2" FROM EACH END - BY OTHERS

POLYFLOW 15 OR 15P SHEET MOLDED DRAIN - OPTIONAL

TOTALFLOW HIGH CAPACITY PERIMETER DRAIN - OPTIONAL

12" DETAIL TAPE APPLIED TO INSIDE AND OUTSIDE CORNERS PREPARED WITH 650 LT LIQUID ADHESIVE OR CALIFORNIA SEALANT AT A RATE OF 250 - 300 SF/GAL OR 650 WB LIQUID ADHESIVE AT A RATE OF 350 - 400 SF/GAL

3/4" FILLET OF DETAIL SEALANT PW OR LM-95 LIQUID MEMBRANE APPLIED TO RAW CONCRETE

WATERSTOP PER MANUFACTURERS RECOMMENDATIONS BY OTHERS

TOTALFLOW CONNECTORS - TEE AND END OUTLETS AVAILABLE - OPTIONAL



OVERVIEW@ PRM MEMBRANE VERTICAL WALL APPLICATION

SPECIAL NOTE: IF ADHESIVE IS REQUIRED FOR SEAMS OR ENDLAPS DO NOT USE 650 WB LIQUID ADHESIVE

© POLYGUARD PRODUCTS, INC.
MATERIALS SEPARATED FOR CLARITY

The information provided is based on data and knowledge considered to be true and accurate and is offered for the users' consideration, investigation and verification, but we do not warrant the results to be obtained. Please read all data sheets, statements, recommendations or suggestions in conjunction with our conditions of sale, which apply to all goods supplied by us.	NOT TO SCALE
	EFFECTIVE DATE: 07/01/2019
	SUPERCEDES: 11/26/2014