

1/8" x 1" METAL TERMINATION STRIP ALIGNED ALONG TOP EDGE OF 650/PRM MEMBRANE AND FASTENED NOT GREATER THAN 8" SPACING.

POLYFLOW 15 /15P MOLDED SHEET DRAIN - FABRIC TOWARD RETENTION SYSTEM

12" STRIP OF 606 TAPE APPLIED TO CLEAN, DRY AND FROST FREE CONCRETE PREPARED WITH 650 LT LIQUID ADHESIVE OR CALIFORNIA SEALANT APPLIED AT A RATE OF 250 - 300 SF/GAL

12" BLINDSIDE MEMBRANE TAIL APPLIED OVER 12" STRIP OF 606 TAPE - PREPARE FABRIC SIDE OF BLINDSIDE MEMBRANE WITH 650 LT LIQUID ADHESIVE OR CALIFORNIA SEALANT AT A RATE OF 50 - 75 SF/GAL

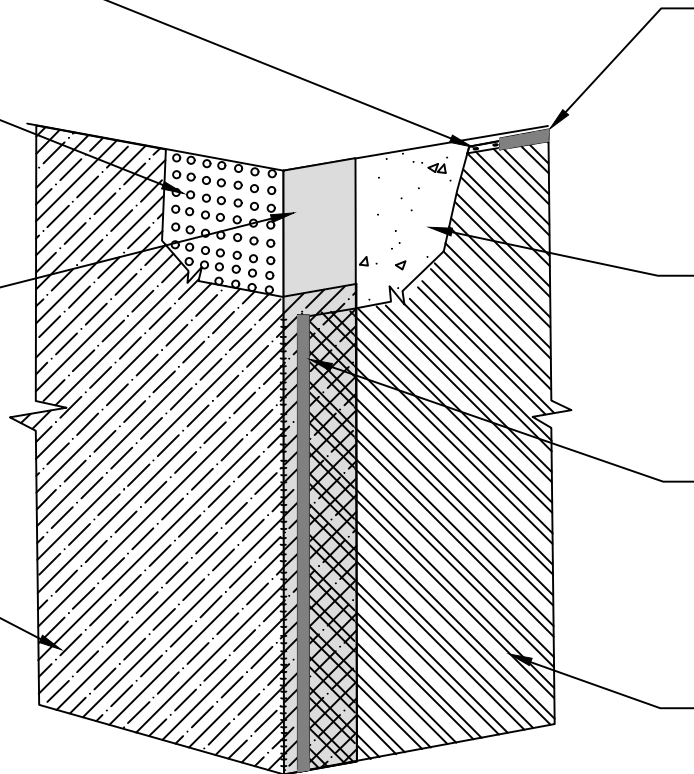

MINIMUM 90 MILS OF DETAIL SEALANT PW APPLIED TO THE TERMINAL EDGE OF TERMINATION STRIP COVERING FASTENERS AND EXTENDING 1/2" ABOVE AND BELOW TERMINATION STRIP

CLEAN DRY FROST FREE CONCRETE

MINIMUM 90 MILS OF DETAIL SEALANT PW APPLIED TO VERTICAL EDGE OF 650 / PRM MEMBRANE

650 OR PRM MEMBRANE APPLIED TO CLEAN, DRY AND FROST FREE SUBSTRATE PREPARED WITH 650 LT LIQUID ADHESIVE OR CALIFORNIA SEALANT AT A RATE OF 250 - 300 SF/GAL OR 650 WB LIQUID ADHESIVE AT A RATE OF 350 - 400 SF/GAL - WB CAN ONLY BE USED ON THE 650 MEMBRANE WALL NOT BLINDSIDE WALL

BS14

SECTION@ BLINDSIDE TIE IN WITH 650/PRM AT OUTSIDE CORNER

© POLYGUARD PRODUCTS, INC.
MATERIALS SEPARATED FOR CLARITY

The information provided is based on data and knowledge considered to be true and accurate and is offered for the users' consideration, investigation and verification, but we do not warrant the results to be obtained. Please read all data sheets, statements, recommendations or suggestions in conjunction with our conditions of sale, which apply to all goods supplied by us.	NOT TO SCALE
	EFFECTIVE DATE: 01/18/2022
	SUPERCEDES: 03/05/2021